



Electronic people counters

advising about electronic counting and visitor tracking

00.400.XX SPOTTIC (NU) SENSOR Round

SPECIFICATIONS STANDARD HOUSING

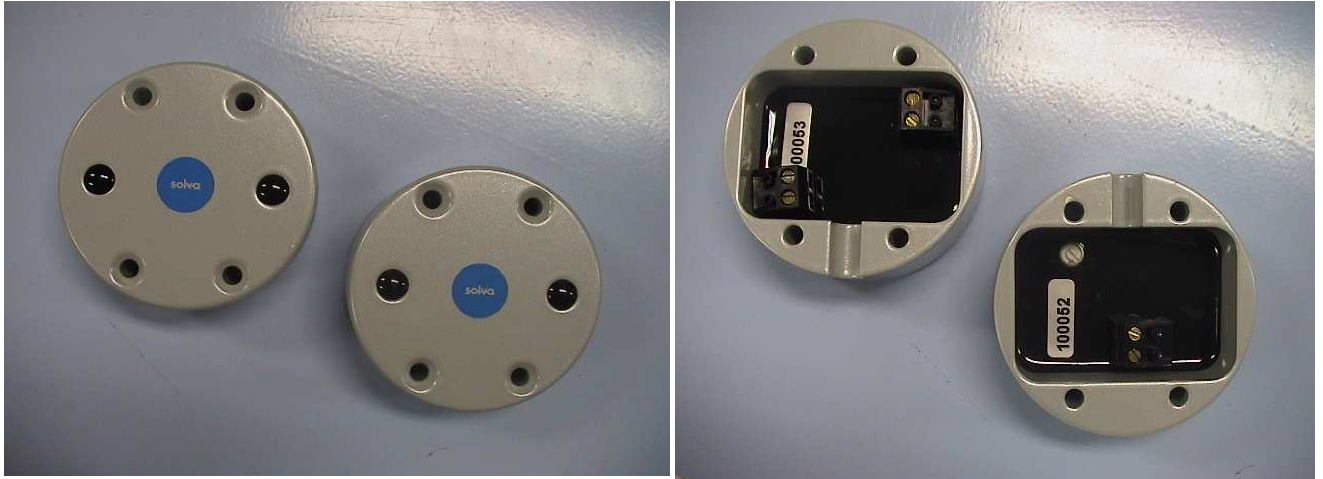

FRONT- and BACKVIEW

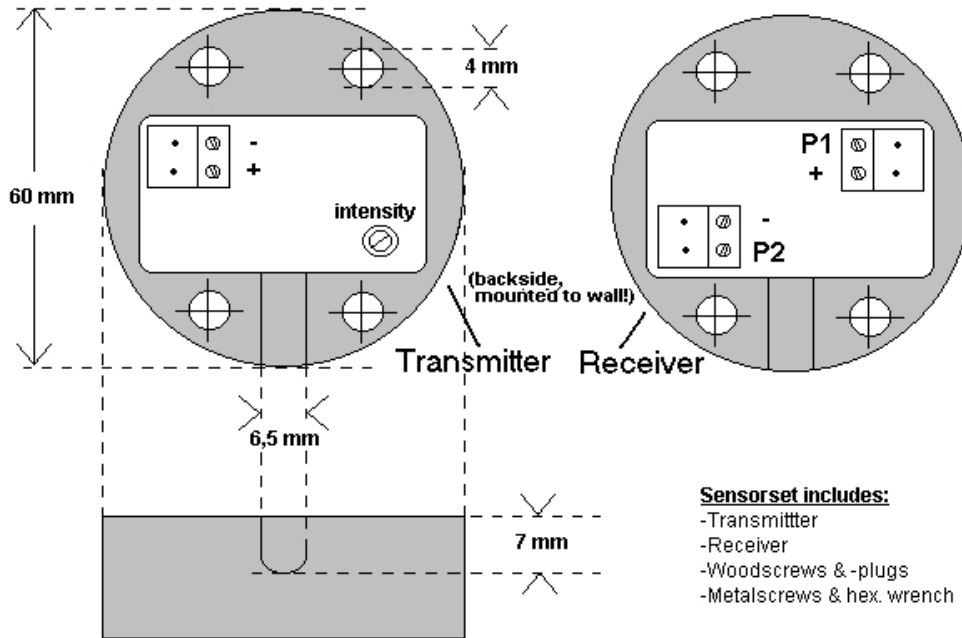

DIMENSIONS



Electronic people counters

advising about electronic counting and visitor tracking

SOLVA SPOTTIC (NU) SENSOR Round

SPECIFICATIONS OEM HOUSING

FRONT- and SIDEVIEW
DIMENSIONS (mm)

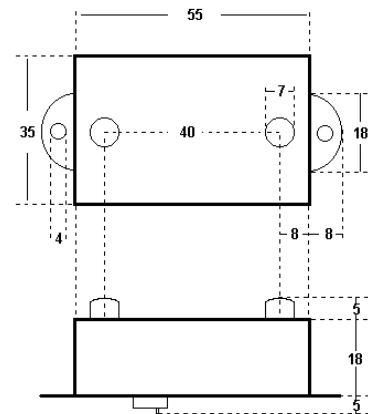

SOLVA reserves the right to make changes without notice!

SOLVA SPOTTIC (NU) SENSOR Round**SENSOR CHARACTERISTICS**(Operating temperature $T_o = -20$ to $+70$ °C)

Emitter		IR-emitter diode			
Working principle		Opposed (transmitter/receiver)			
Parameter	Test Condition	Min.	Typ.	Max.	Unit
Peak wave length			880		Nm
Maximum adjustable detection distance			15		M
Touch frequency			10		kHz
Operating Temperature		-20		+70	°C

ELECTRICAL DATA(Operating temperature $T_o = -20$ to $+70$ °C)

Receiver					
Output	Output transistor PNP				
Supply voltage polarity protection	Yes				
Short circuit protection	Yes				
Overload protection	Yes				
Output reversal current protection	Yes				
Receiver					
Parameter	Test Condition	Min.	Typ.	Max.	Unit
Supply voltage V_{CC}		10		30	V
Supply voltage ripple				10	%
Current consumption	Load resistance $R_L = \infty$			15	mA
Output load current				200	mA
Response time			1.3		Ms



Electronic people counters

advising about electronic counting and visitor tracking

SOLVA SPOTTIC (NU) SENSOR Round

Transmitter					
Supply voltage polarity protection	Yes				
Transmitter					
Parameter	Test Condition	Min.	Typ.	Max.	Unit
Supply voltage V_{CC}		10		30	V
Supply voltage ripple				10	%
Current consumption				25	mA

MECHANICAL DATA

Degree of protection, colour & temperature	Customer request
Dimensions (Receiver Rx)	PCB: approx. 30x48 mm excl. Housing Height approx 16 mm incl connectors excl. LEDS
Dimensions (Transmitter Tx)	PCB: approx. 30x30 mm excl. Housing Height approx 16 mm incl connectors excl. LEDS

SOLVA reserves the right to make changes without notice!